

CLASS 300

BLIND FLANGES

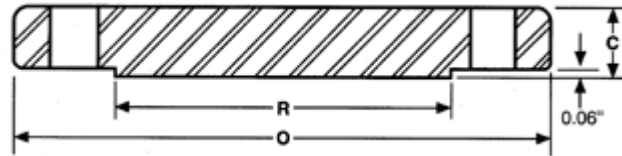

	Nominal size	Outside diam. of flange	Thick. of flange	Diam. of raised face	No. of holes	Diam. of holes	Diam. of bolts	Diam. of bolt circle	Approx. weight pounds Kg
		O	C	R					
<i>in.</i>	1/2"	3.75	0.56	1.38	4	0.62	1/2	2.62	2
<i>mm.</i>		95.3	14.2	35.1		15.7	12.7	66.5	1
<i>in.</i>	3/4"	4.62	0.62	1.69	4	0.75	5/8	3.25	3
<i>mm.</i>		117.3	15.7	42.9		19.1	15.9	82.6	1
<i>in.</i>	1"	4.88	0.69	2.00	4	0.75	5/8	3.50	3
<i>mm.</i>		124.0	17.5	50.8		19.1	15.9	88.9	1
<i>in.</i>	1 1/4"	5.25	0.75	2.50	4	0.75	5/8	3.88	4
<i>mm.</i>		133.4	19.1	63.5		19.1	15.9	98.6	2
<i>in.</i>	1 1/2"	6.12	0.81	2.88	4	0.88	3/4	4.50	6
<i>mm.</i>		155.4	20.6	73.2		22.4	19.1	114.3	3
<i>in.</i>	2"	6.50	0.88	3.62	8	0.75	5/8	5.00	8
<i>mm.</i>		165.1	22.4	91.9		19.1	15.9	127.0	4
<i>in.</i>	2 1/2"	7.50	1.00	4.12	8	0.88	3/4	5.88	12
<i>mm.</i>		190.5	25.4	104.6		22.4	19.1	149.4	5
<i>in.</i>	3"	8.25	1.12	5.00	8	0.88	3/4	6.62	16
<i>mm.</i>		209.6	28.4	127.0		22.4	19.1	168.1	7
<i>in.</i>	3 1/2"	9.00	1.19	5.50	8	0.88	3/4	7.25	21
<i>mm.</i>		228.6	30.2	139.7		22.4	19.1	184.2	10
<i>in.</i>	4"	10.00	1.25	6.19	8	0.88	3/4	7.88	27
<i>mm.</i>		254.0	31.8	157.2		22.4	19.1	200.2	12
<i>in.</i>	5"	11.00	1.38	7.31	8	0.88	3/4	9.25	35
<i>mm.</i>		279.4	35.1	185.7		22.4	19.1	235.0	16
<i>in.</i>	6"	12.50	1.44	8.50	12	0.88	3/4	10.62	50
<i>mm.</i>		317.5	36.6	215.9		22.4	19.1	269.7	23
<i>in.</i>	8"	15.00	1.62	10.62	12	1.00	7/8	13.00	81

mm.		381.0	41.1	269.7		25.4	22.2	330.2	37
in.	10"	17.50	1.88	12.75	16	1.12	1	15.25	124
mm.		444.5	47.8	323.9		28.4	25.4	387.4	56
in.	12"	20.50	2.00	15.00	16	1.25	1 1/8	17.75	185
mm.		520.7	50.8	381.0		31.8	28.6	450.9	84
in.	14"	23.00	2.12	16.25	20	1.25	1 1/8	20.25	250
mm.		584.2	53.8	412.8		31.8	28.6	514.4	113
in.	16"	25.50	2.25	18.50	20	1.38	1 1/4	22.50	295
mm.		647.7	57.2	469.9		35.1	31.8	571.5	134
in.	18"	28.00	2.38	21.00	24	1.38	1 1/4	24.75	395
mm.		711.2	60.5	533.4		35.1	31.8	628.7	179
in.	20"	30.50	2.50	23.00	24	1.38	1 1/4	27.00	505
mm.		774.7	63.5	584.2		35.1	31.8	685.8	229
in.	24"	36.00	2.75	27.25	24	1.62	1 1/2	32.00	790
mm.		914.4	69.9	692.2		41.1	38.1	812.8	358

✓ Flanges over diameter of 24 " shall be according to standard ASME B.16.47